

Handlebar Assembly Method

SM-SW10/SM-SW10R & SW-C810C/SW-8S40C/SW-8S40RC

Note:

- Cables run through the inside of the handlebar, so take care when adjusting the angle of the handlebar and the switches.
- When replacing the handlebar, refer to "Reconnecting the cables at the SC bracket side and switch side".
- Refer to the manufacturer's Service Instructions for the handlebar stem and handlebar for the tightening torque for the handlebar stem.

Handlebar wiring

Pass the two cables of the SC bracket through the hole in the handlebar so that they project from both ends of the handlebar. At this time, the cable which has three terminals attached should project from the right end of the handlebars, and the cable with two terminals attached should project from the left end. Next, pass the cables of the right and left switches through the hole in the handlebar so that they project from both ends of the handlebar.

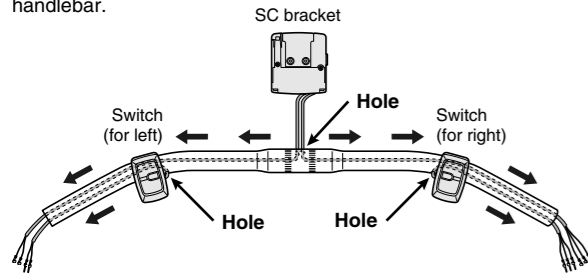

Connecting the cables at the SC bracket side and switch side

The following describes the procedures for the right side of the switch. Connect the left side in the same way.

1. Pass each cable on the SC bracket side through the shrink tube.

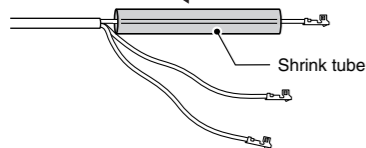

2. Connect the switch side and SC bracket side connectors making sure to connect only cables of the same color.

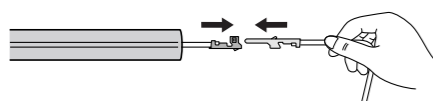

Note:

- Make sure not to get the colors mixed up.
 - Cables on the right side of the switch (x3): gray/green/blue
 - Cables on the left side of the switch (x2): green/blue
- For the connection pay attention to the direction of the connectors.

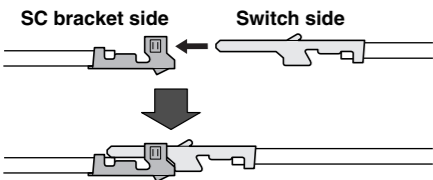

3. Position the shrink tube so that its center is at the connection point of the cables.

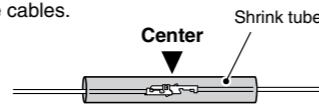

4. Use an industrial dryer to shrink the tube.

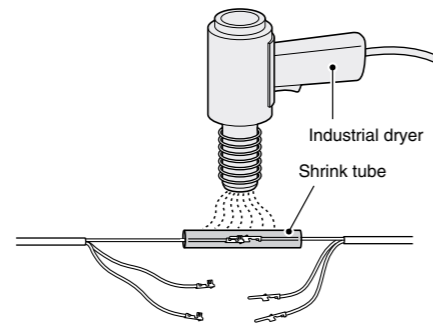

Note:

- The shrink tube starts to shrink at 115°C. Keep the heat application environment temperature between 140°C and 160°C. Apply heat to the tube carefully while checking its condition.
- Be careful not to melt the plastic sheath on the cables.
- Please be careful of the hot air when using the dryer to avoid burns.

5. Completely contracted shrink tube.

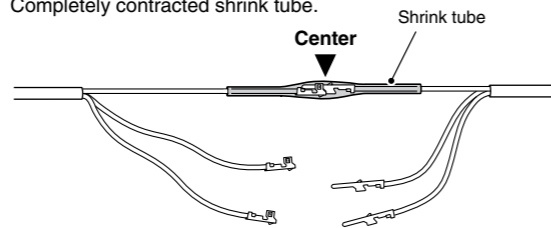

Note:

Make sure the entire tube, from end to end, is properly shrunk.

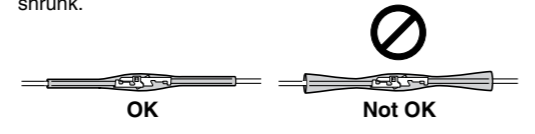

Handlebar stem wiring

1. Pass the two cables (computer unit cable and front suspension cable) through the hole in the bottom of the steering column.

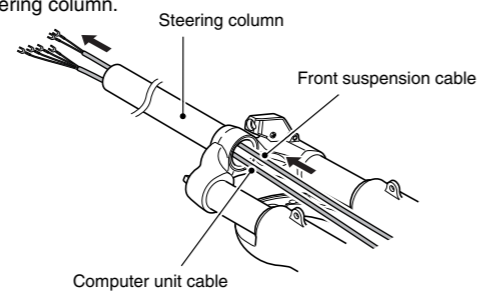

2. Pass the two cables through the hole in the bottom of the handlebar stem as shown in the illustration.

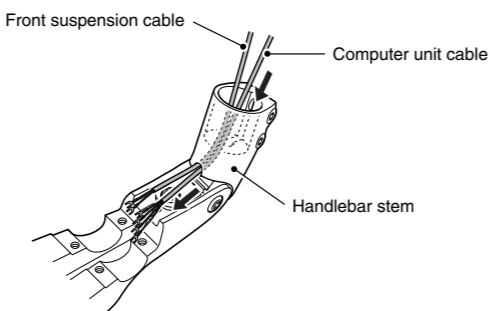

3. Secure the handlebar stem to the steering column. Refer to the manufacturer's Service Instructions for the handlebar stem for the tightening torque.

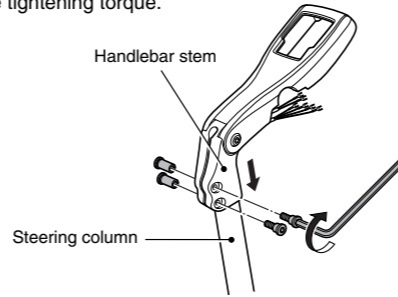

Connecting the computer unit cable and front suspension cable to the SC bracket

1. Open the cover of the SC bracket and connect the terminals (4 terminals + 2 terminals) of the two cables of the handlebar stem. At this time, be careful not to mix up the colors indicated on the SC bracket and the colors of the cables.

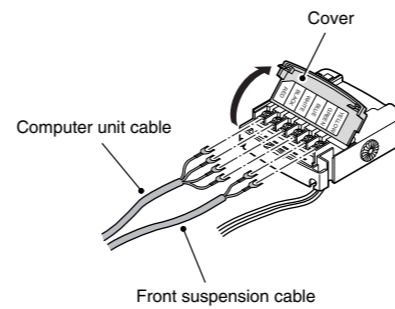

2. Place the cables into the groove in the SC bracket.

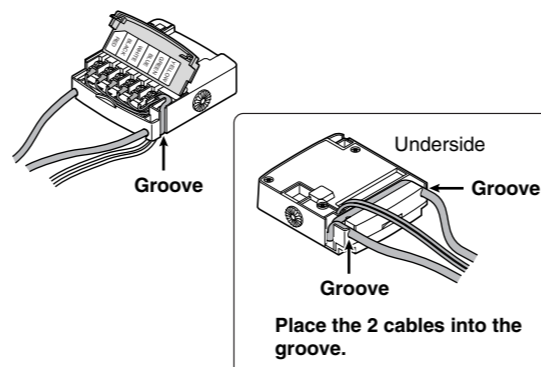

Installing the handlebar and SC bracket to the handlebar stem

Be careful not to get the cables clamped in the handlebar stem during installation.

1. Insert the included battery (CR-2032) into the FLIGHT DECK.
2. Insert the FLIGHT DECK securely into the SC bracket until it clicks into place.

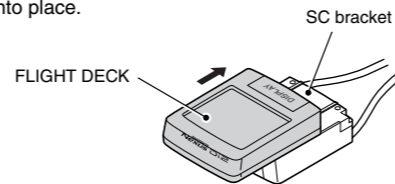

3. Insert the SC bracket with the FLIGHT DECK installed into the handlebar stem.

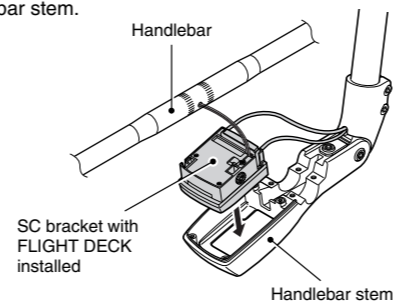

4. After inserting the handlebar into the handlebar stem, run the cables through the middle of the handlebar stem so that they go into the groove on the underside of the handlebar fixing cover. Then install the handlebar fixing cover to the handlebar stem and secure the handlebar with the four bolts. Be careful not to clamp the cables between the handlebar fixing cover and the handlebar at this time. Refer to the manufacturer's Service Instructions for the handlebar stem and handlebar for the tightening torque for the handlebar fixing cover.

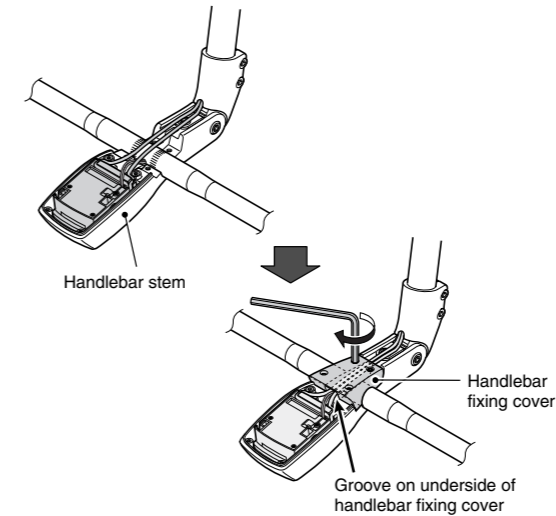

5. Install the bottom cover to the handlebar stem. Refer to the manufacturer's Service Instructions for the handlebar stem for the tightening torque.

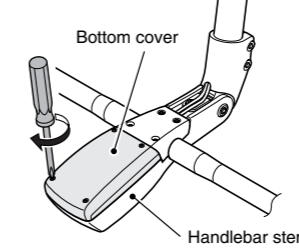

Battery replacement

1. Remove the bottom cover from the handlebar stem.

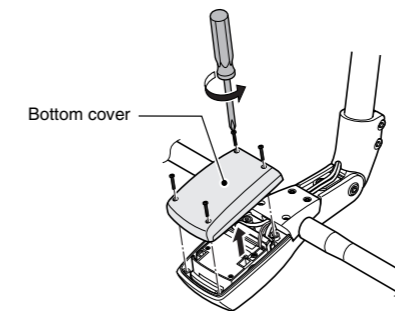

2. Remove the SC bracket with the FLIGHT DECK installed from the handlebar stem.

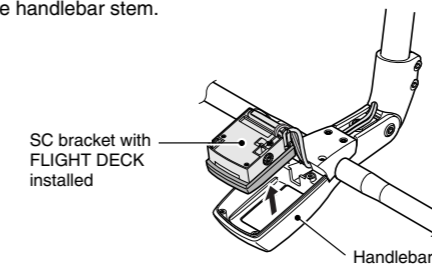

3. Replace the battery (CR-2032) with a new one while referring to "Battery replacement" in the Service Instructions for the whole system.

4. After replacing the battery, note the following when reinstalling the parts.
 - Check that the cables are inside the groove in the SC bracket.
 - Be careful not to clamp the cables when installing the bottom cover to the handlebar stem.

Reconnecting the cables at the SC bracket side and switch side

Perform the following procedures if the cables get disconnected as a result of replacing the handle or other cause.

1. Cut the cable at both ends of the shrink tube.

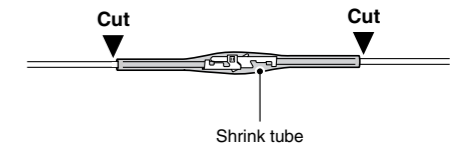

2. Remove the plastic sheath from the cables on the switch side and SC bracket side using a wire stripper.

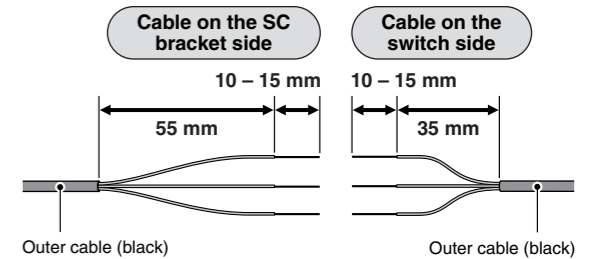

Recommended wire stripper hole diameter

- Cable exterior: 1.0 mm
- Cable interior: 0.5 mm

3. After passing the SC bracket side cable through the shrink tube, twist the switch side and SC bracket side connectors together making sure to connect only cables of the same color.

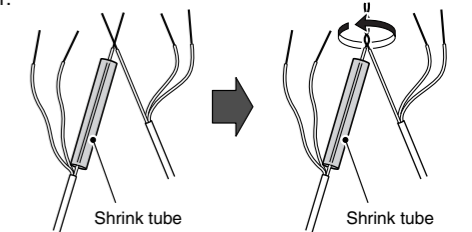

Note:

Connect the cables making sure not to get the colors mixed up.

4. Position the shrink tube as illustrated in the figure. Use an industrial dryer to shrink the tube.

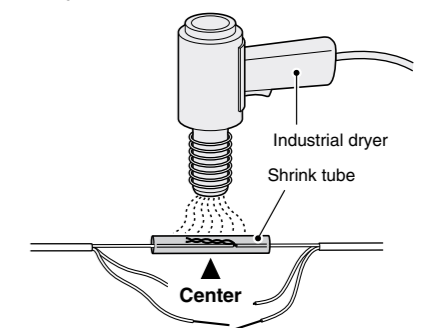

These service instructions are printed on recycled paper. Please note: Specifications are subject to change for improvement without notice. (English)

SHIMANO

SHIMANO AMERICAN CORPORATION
One Holland, Irvine, California 92618, U.S.A. Phone: +1-949-951-5003

SHIMANO EUROPE B.V.
Industrieweg 24, 8071 CT Nunspeet, The Netherlands Phone: +31-341-272222

SHIMANO INC.
3-77 Oimatsu-cho, Sakai, Osaka 590-8577, Japan